

# 783 SF of Retail Space

**GRAPEVINE, TX**

**600 W. Northwest Highway**



**Location:** NWC of Northwest Highway & Scribner St. (Lighted intersection).

**Tenants:** Old West Café, Domino's Pizza & I.D. Floors & More.

**Traffic:** Over 25,000 CPD (City of Grapevine 3/2005).

**Parking:** 8.38/1000!

**Available:** Suite C – formerly Karen's Barber Shop!

**Rent:** \$16.00/SF + NNN's.

**For further information contact: Rich Muller**



**Vintage Realty**

**2980 Long Prairie Rd., Suite D**

**Flower Mound, TX 75022**

**972/355-0669 or Fax 972/355-5477**

**email: [Rich@VintageRealty.net](mailto:Rich@VintageRealty.net) or, [www.VintageRealty.net](http://www.VintageRealty.net)**

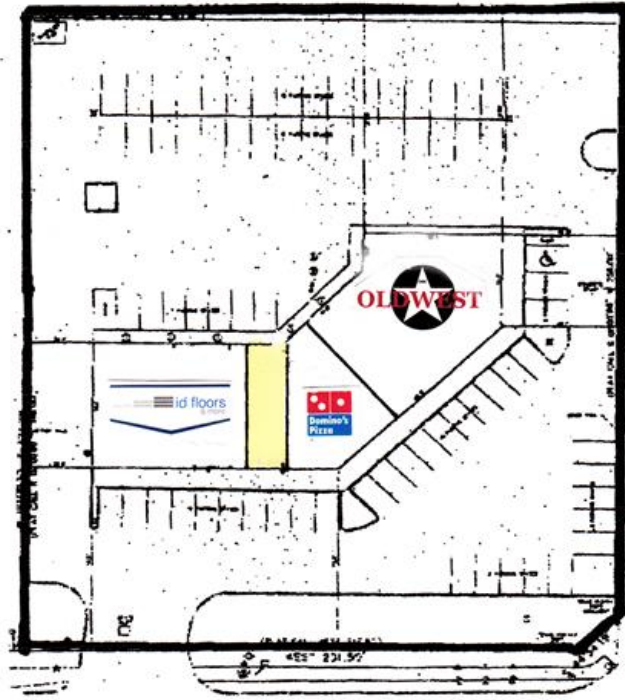

### NORTHWEST HIGHWAY

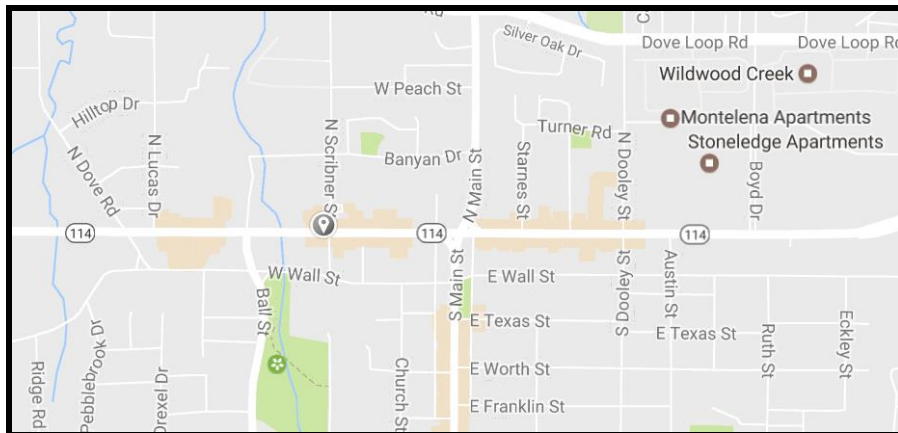

This information is believed to be accurate, but no representation or warranty, express or implied, as to its accuracy or completeness is made by any party. The presentation of this property is submitted subject to errors, omissions, change of price or prior sale or lease, or withdrawal without notice.